

Measuring for your new Wave curtains is easier than you might think! All you have to do is follow our simple tips, double-check everything you do, and set aside some time to do it. Happy measuring!

Standard Windows

Recess Fitting



Exact Fitting

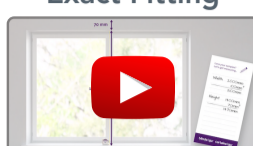

These handy video guides will walk you through measuring for **recess fitting** (fitting inside the window recess) and **exact fitting** (fitting onto the wall above the recess). **We would always recommend exact fitting for our Wave Curtains.**

For a step-by-step written guide and for advice if your windows are a little more unusual (e.g. bay windows, or recesses that are partly tiled), keep scrolling down.

Exact fitting (recommended)

Measure the full width and height of the recess [the size of the hole if you like] and add a little extra to the top and to each side, we'll make the Wave curtains to the size you specify with no deductions.

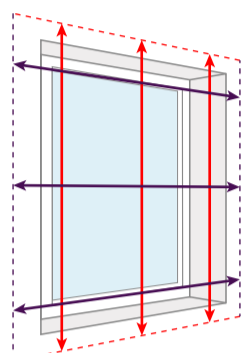

- To minimize light leakage **we recommend that the Wave curtains overlap the window recess by at least 150mm at the top and on each side**
- The overlap at the bottom is a matter of personal choice but please **take into account obstacles** such as radiators

Top-Tip:

If you are **replacing existing curtains** and you want the same size, simply measure the width of the pole or track, and the drop from the top of the pole or track to the bottom of the curtains, and specify exact fitting, we will make your Wave curtains the same size overall (we will send the track with your Wave curtains, so the track will be included in the size).

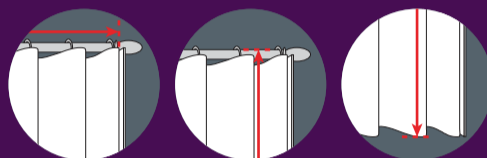

Recess fitting

Measure the full width and height of the recess [the size of the hole if you like] and we will make the appropriate deductions to ensure a perfect fit.

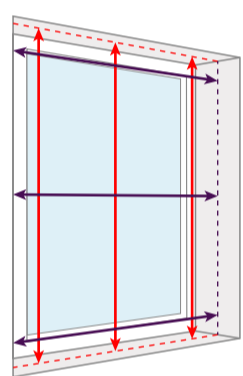

- **Measure in 3 places** for both the width and the drop, **use the smallest measurement**
- **Don't make any deductions**, we'll deduct 10mm from the width and 15mm from the drop to ensure your Wave curtains fit perfectly
- **Use a metal tape measure**, cloth ones can stretch and give you inaccurate measurements

Top-Tip:

Check that your recess is deep enough to fit the Wave curtains into, also bearing in mind any obstructions such as handles.

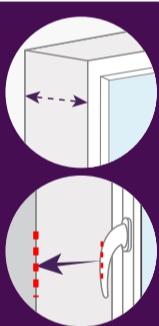

Depth Needed for Wave Curtains
75mm

Other Windows

Part-tiled recesses

If you have tiles part-way up your recess (often the case in kitchens and bathrooms) then the space between them is most likely to be the narrowest point in the recess.

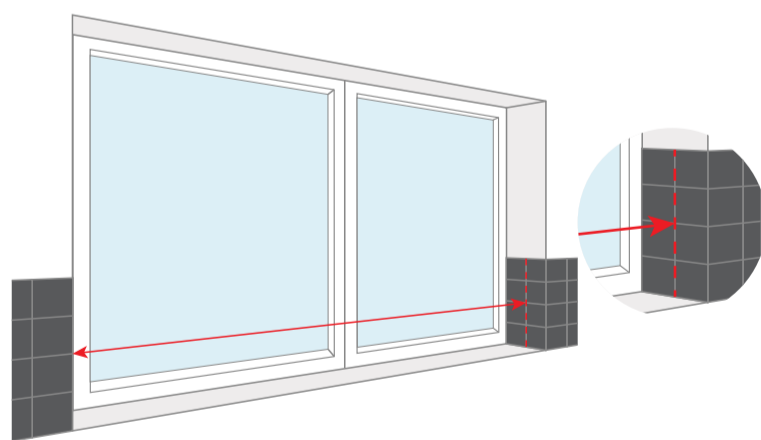

Measure between the tiles to ensure your Wave curtains will fit.

Top-Tip:

Do the same if you have a picture rail, skirting board or other items on the inside of the recess.

Bay windows, half-bays & L-shaped windows

We recommend for these windows that you fit the Wave curtains onto the wall outside the bay covering the whole space in one run. Refer back to our 'exact fitting' advice at the top of this page.

