

Measuring for your new blinds is easier than you might think! All you have to do is follow our simple tips, double-check everything you do, and set aside some time to do it. Happy measuring!

This guide works for:

- Standard Roller blinds
- Double Roller blinds
- Enjoy Roller blinds
- Illusion Roller blinds

Standard Windows

Recess Fitting



Exact Fitting



These handy video guides will walk you through measuring for **recess fitting** (fitting the blind inside the window recess) and **exact fitting** (fitting the blind onto the wall above the recess).

For a step-by-step written guide and for advice if your windows are a little more unusual (e.g. bay windows, or recesses that are partly tiled), keep scrolling down.

Recess fitting

Measure the full width and height of the recess [the size of the hole if you like] and we will make the appropriate deductions to ensure a perfect fit.

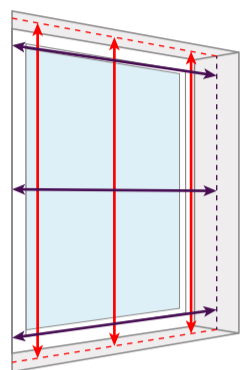

- **Measure in 3 places** for both the width and the drop. **For the width**, compare the measurement at the top of the recess with the smallest of the measurements you've taken - **if the difference between those is less than 25mm, use the measurement at the top of the recess**. If it is not, use the smallest measurement.
- **Don't make any deductions**, we'll deduct from the width to ensure your blind fits perfectly (3mm for standard & double rollers, 10mm for Enjoy & Illusion).
- **Use a metal tape measure**, cloth ones can stretch and give you inaccurate measurements

Top-Tip:

Check that your recess is deep enough to fit the blind into, also bearing in mind any obstructions such as handles (see table).

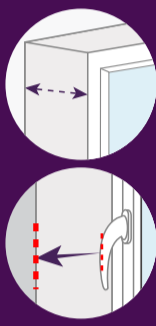

Standard Roller Depth

Top-Fix	Face-Fix
50mm	70mm

Enjoy Roller Depth
85mm

Double Roller Depth

Top-Fix	Face-Fix
120mm	105mm

Illusion Roller Depth
85mm

Exact fitting

Measure the full width and height of the recess [the size of the hole if you like] and add a little extra to the top and to each side, we will make the blind to the size you specify with no deductions.

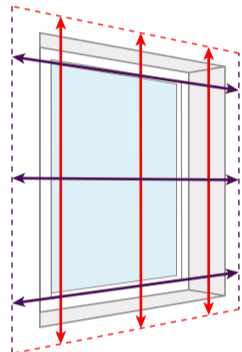

- To minimize light leakage **we recommend that the blind overlaps the window recess by at least 70mm at the top and 50mm each side**
- The overlap at the bottom of the blind is a matter of personal choice but please **take into account obstacles** such as radiators

Top-Tip:

If you are **replacing an existing blind** with one of the same size, simply measure the blind (including its fittings) and specify exact fitting, we will make you one the same size.

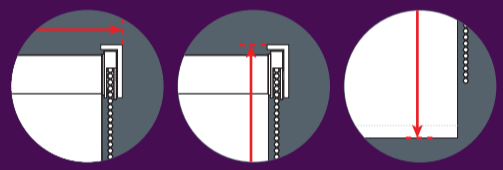

Top-Tip:

The overall width of a roller blind, including its brackets, is approximately 35mm wider than the width of the fabric. You can choose whether to measure for the full bracket-to-bracket width, or for the width you'd like the fabric to cover.

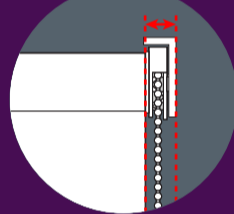

Other Windows

Part-tiled recesses

If you have tiles part-way up your recess (often the case in kitchens and bathrooms) then the space between them is most likely to be the narrowest point in the recess.

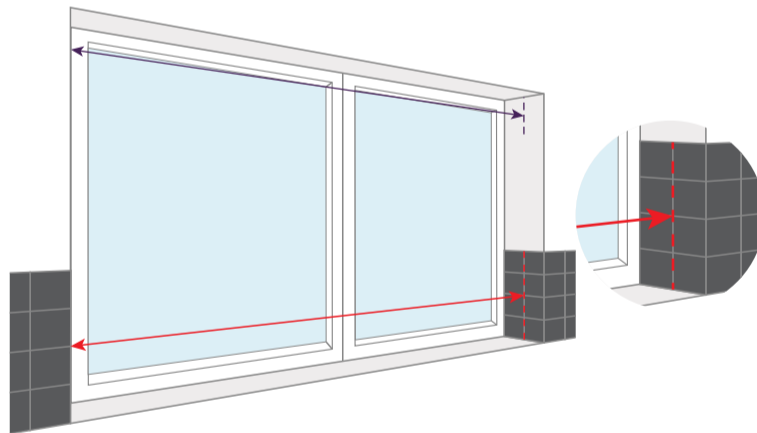

Measure at the top of the recess and between the tiles. Compare the two measurements; if the difference is **less than 25mm**, use the measurement from the top of the recess.

If it is not, use the width between the tiles. You will need to top-fix or face-fix your blind if this is the case.

Top-Tip:

Do the same if you have a picture rail, skirting board or other items on the inside of the recess.

Bay windows, half-bays & L-shaped windows

We have some handy guides already put together especially for roller blinds in bay windows, click on the links below to take a look!

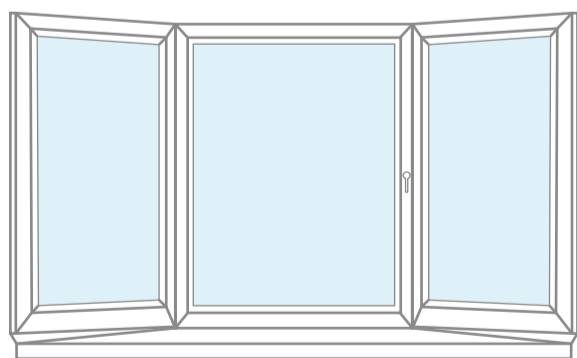

Angled bay windows

You can use these same guides for angled half-bay windows, it's the same principle

[Click here](#) for standard roller blinds

[Click here](#) for double roller blinds

[Click here](#) for Enjoy & Illusion roller blinds

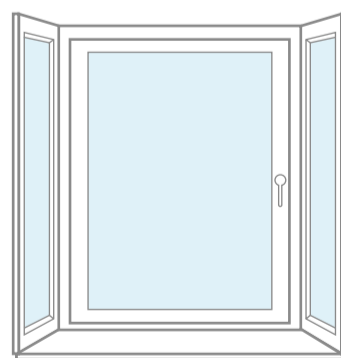

Square bay windows

You can use these same guides for L-shaped windows, it's the same principle

[Click here](#) for standard roller blinds

[Click here](#) for double roller blinds

[Click here](#) for Enjoy & Illusion roller blinds

Unique Features

When you choose exact fitting for a roller blind you are given two further options, either fabric width or bracket-to-bracket width (these options are not available for Enjoy or Illusion roller blinds).

Fabric Width

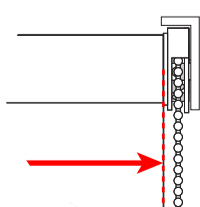

Fabric width is exactly as it sounds, the width of the fabric itself. **We don't recommend measuring for fabric width if you're fitting the blind inside a recess.**

Bracket-to-Bracket Width

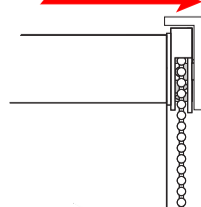

Bracket-to-bracket width is the full width of the blind including the fittings. **This is approximately 35mm wider than the width of the fabric.**