

Measuring for your new blinds is easier than you might think! All you have to do is follow our simple tips, double-check everything you do, and set aside some time to do it. Happy measuring!

## Standard Windows

### Recess fitting (recommended)

Measure the full width and height of the recess [the size of the hole if you like] and we will make the appropriate deductions to ensure a perfect fit.

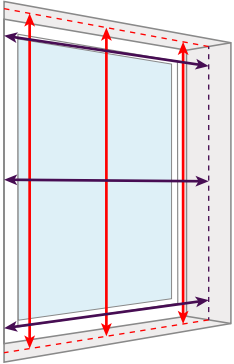

- **Measure in 3 places** for both the width and the drop, **use the smallest measurement**
- **Don't make any deductions**, we'll make the necessary calculations and allowances to ensure a perfect fit
- **Use a metal tape measure**, cloth ones can stretch and give you inaccurate measurements

#### Top-Tip:

Check that your recess is deep enough to fit the blind into, also bearing in mind any obstructions such as handles.

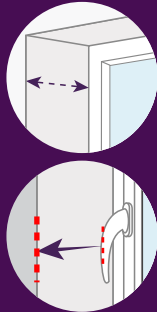

TotalShade Required Depth

75mm

### Exact fitting

Measure the full width and height of the recess [the size of the hole if you like] and add a little extra to the top and to each side, we will make the blind to the size you specify with no deductions.

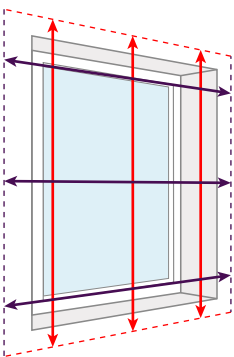

- To minimize light leakage **we recommend that the blind overlaps the window recess by at least 50mm at the top and 50mm each side**
- The overlap at the bottom of the blind is a matter of personal choice but please **take into account obstacles** such as radiators - if you have a window sill then there's no need to add any overlap at the bottom, as the blind will rest on the sill.

## Other Windows

Partly tiled recesses

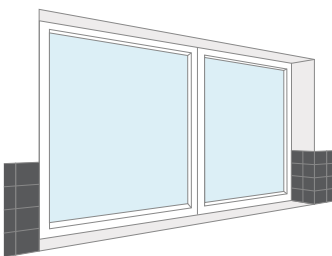

Angled bay windows

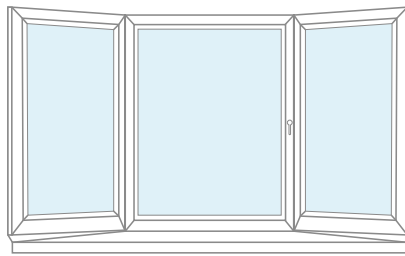

Square bay windows

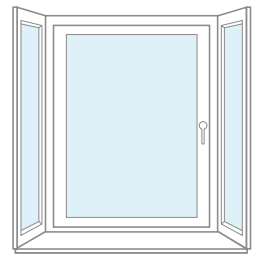

Due to the design and fitting methods of our TotalShade Pleated Blinds, there are certain window spaces in which we would not recommend attempting to fit them, such as recesses that feature a significant difference between the width at their narrowest point and their widest (like partly tiled windows that are often found in bathrooms and kitchens), bay windows and half bay windows.