

Measuring for your new blinds is easier than you might think! All you have to do is follow our simple tips, double-check everything you do, and set aside some time to do it. Below is a handy guide for measuring for **Roman blinds**.

## Standard Windows

### Recess Fitting



### Exact Fitting



These handy video guides will walk you through measuring for **recess fitting** (fitting the blind inside the window recess) and **exact fitting** (fitting the blind onto the wall above the recess).

For a step-by-step written guide and for advice if your windows are a little more unusual (e.g. bay windows, or recesses that are partly tiled), keep scrolling down.

### Recess fitting

If you want your blind to fit **inside the window recess**.

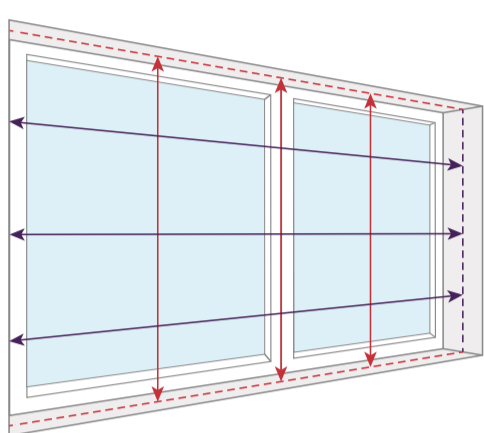

Measure the full width and height of the recess [the size of the hole if you like] and we will make the appropriate deductions to ensure a perfect fit.

- **Measure in 3 places** for both the width and the drop, **use the smallest measurement**
- **Don't make any deductions**, we'll deduct 10mm from the width to ensure your blind fits perfectly
- **Use a metal tape measure**, cloth ones can stretch and give you inaccurate measurements

#### Top-Tip:

Check that your recess is deep enough to fit the blind into, also bearing in mind any obstructions such as handles.

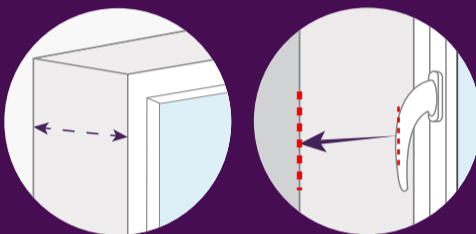

Roman Blind Depth  
45mm

### Exact fitting

If you want your blind to fit **outside the window recess**.

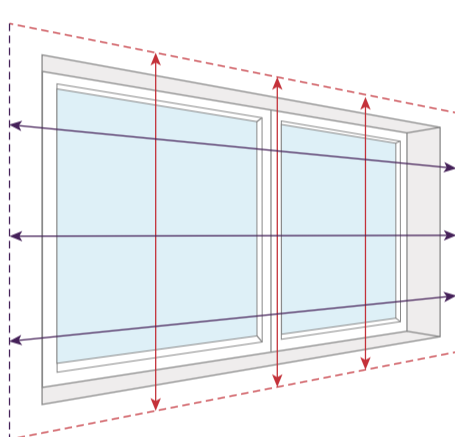

Measure the full width and height of the recess [the size of the hole if you like] and add a little extra to the top and to each side, we will make the blind to the size you specify with no deductions

- To minimize light leakage **we recommend that the blind overlaps the window recess by at least 70mm at the top and 50mm each side**
- The overlap at the bottom of the blind is a matter of personal choice but please **take into account obstacles** such as radiators

#### Top-Tip:

If you are **replacing an existing blind** with one of the same size, simply measure the blind (including its fittings) and specify exact fitting, we will make you one the same size.



## Measuring Tips for Other Windows

### Fitting inside a part-tiled recess

If you have tiles part-way up your recess (often the case in kitchens and bathrooms) then the space between them is most likely to be the narrowest point in the recess.

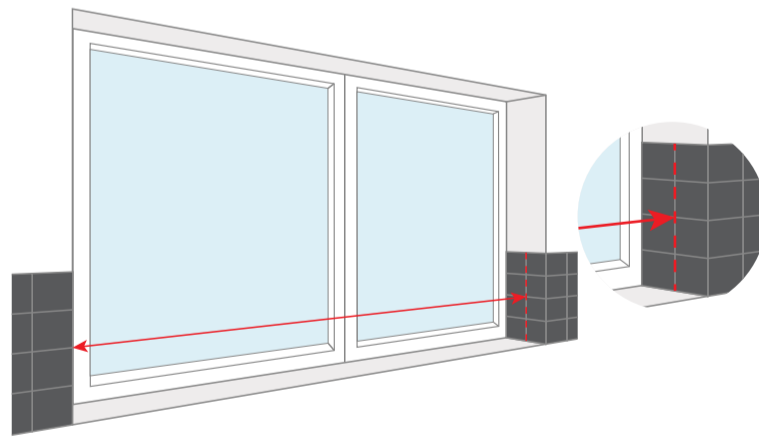

Measure **between the tiles** to ensure your blind will fit.

#### Top-Tip:

Do the same if you have a picture rail, skirting board or other items on the inside of the recess.

### Bay windows, half-bays & L-shaped windows

We have some handy guides already put together especially for Roman blinds in bay windows, click on the links below to take a look!

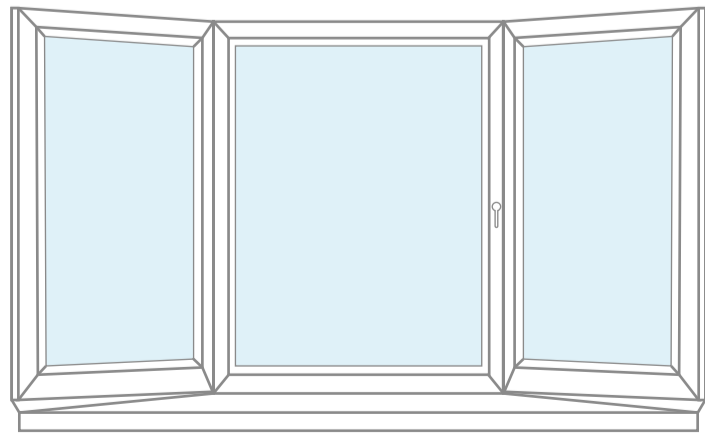

#### Angled bay windows

[Click here](#) for our handy guide

You can use this same guide for angled half-bay windows, it's the same principle

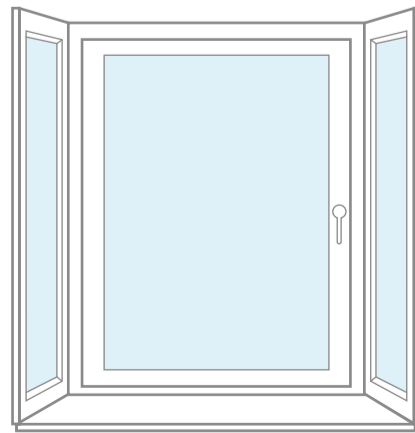

#### Square bay windows

[Click here](#) for our handy guide

You can use this same guide for L-shaped windows